

Aluminum Windows for Metal Buildings



Slim Line II Self-Flashing Fixed Accent Windows

SPECIFICATIONS

GENERAL: Slim Line II Self-Flashing Fixed Accent Window Unit shall be as furnished by **PREMIER** Products, Inc., Monroe, Louisiana as shown on drawings.

MATERIALS: All Sections of Slim Line II Unit shall be of commercial quality 6063-T5 extruded aluminum alloy. Frame members shall be no less than 2-1/2" in depth and wall thickness no less than .062".

CONSTRUCTION: All joints of frame shall be neatly fitted and secured in a manner to utilize the full strength of the members connected. Members shall be adequately sealed to assure against moisture seepage into surrounding wall construction.

GLAZING: Window Unit shall be designed to accept glazing of 1/8" and/or 1/2" hermetically sealed with two sheets of glass.

ERECTION: Erection shall be by others, using only skilled mechanics. Units shall be plumb to wall panel. All joints formed around perimeter of window shall be sealed and fastened to insure against moisture seepage into surrounding wall construction following complete installation.

Units shall be factory glazed with outside aluminum snap-in glazing bead with vinyl seal. Glazing leg rebates shall be a minimum of 3/4" in height and serrated to receive backbed compound.

PANEL: Units that are to receive a bottom panel are to be factory glazed as outlined for glass. Thickness of finished panel to be 1/2". Panels can be a variety of designs to satisfy customer's needs.

FINISH: Exposed surfaces of aluminum members shall be cleaned and etched followed by a baked on enamel finish, uniform in color, clean and free from serious blemishes. Paint thickness shall range from 0.80 to 1.20 mil and color shall be **PREMIER** Series Bronze.

PREMIER SERIES

WINDOW INSTALLATION DETAILS FOR METAL BUILDINGS

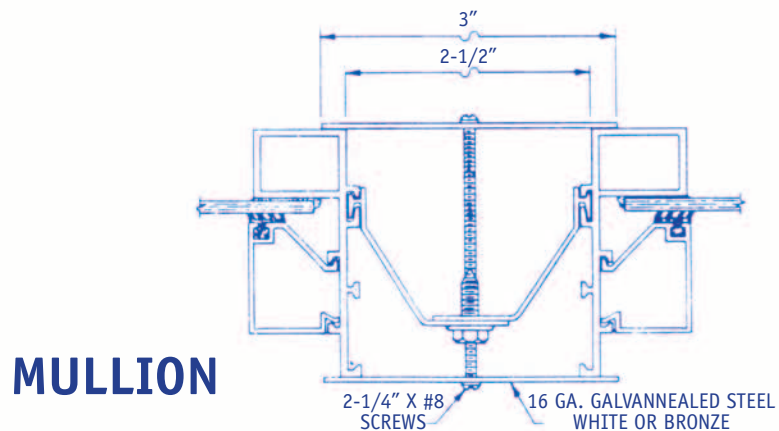
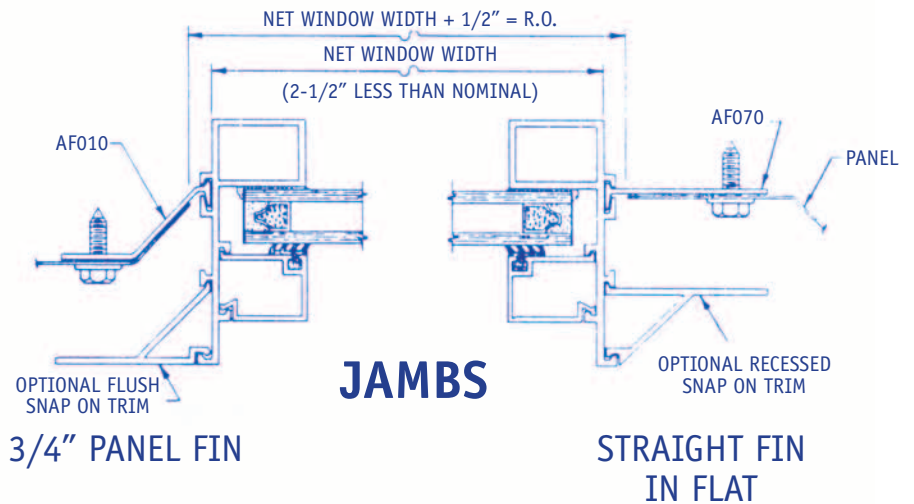
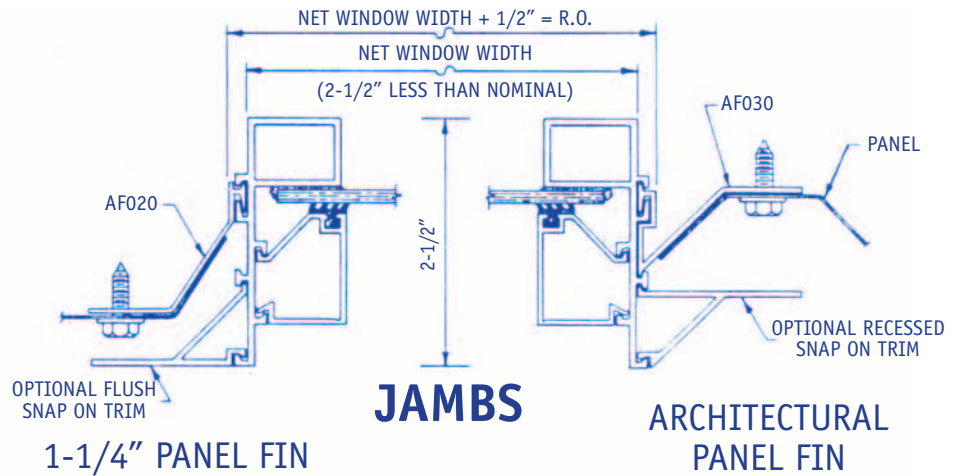
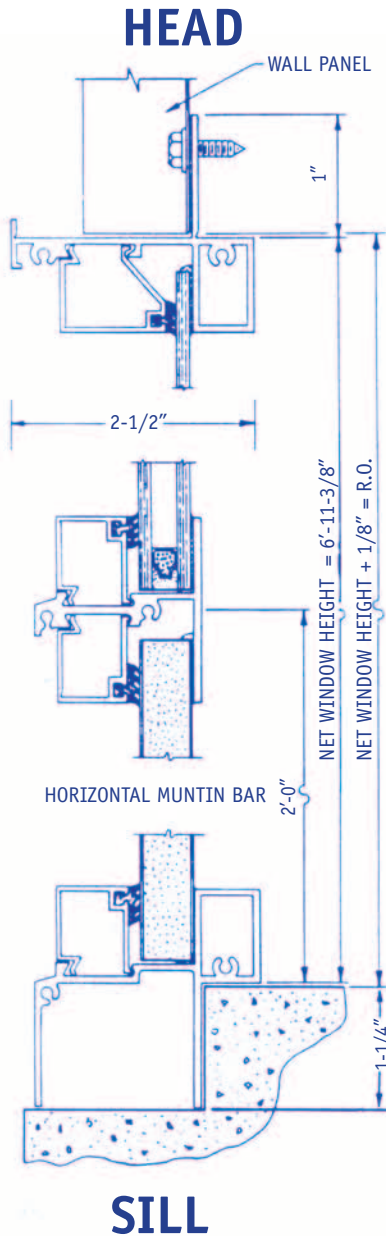

- Aluminum fins match panel profile for snug fit, and snap-on architectural trim gives the window that finished look. By designing this window to fit almost any metal building opening, we solved a lot of installation problems and made a window with features as attractive as they are practical.
- With **PREMIER'S** unique fins, windows can be installed from inside or outside depending on user's preference. Follow erection instructions carefully to obtain a secure, weatherproof installation.
- **PREMIER SERIES** Slim Line II windows can be glazed with a variety of glass such as D.S.B. or hermetically sealed, insulated, tinted or clear. **PREMIER** recommends tempered, or laminated glass when the window unit is within 18" of the floor line or within 36" from a door opening.